

LINE	BEARING	DISTANCE
L1	S 02°19'12" W	24.76'
L2	N 89°43'24" W	232.24'

CURVE	DEGREE OF CURVE	RADIUS	DELTA ANGLE	CHORD BEARING	CHORD LENGTH	ARC LENGTH
C1	1°38'21"	2904.93'	5°27'03"	S 02°00'45" E	276.26'	276.36'
C2	13°32'34"	423.07'	10°04'30"	S 10°29'45" E	74.30'	74.39'

**JAMES C. HEIRD
& ELEANOR M. GREEN**
113,050 ACRES
DDC. #201912173

J.W. HICKEY, ET UX
16,113 ACRES
V. 1238, P. 1080

JOE W. HICKEY
13,333 ACRES
DDC. #201412147

**CHARLES E. SCOTT
& KATHRYN SCOTT**
9,011 ACRES
V. 2170, P. 599

**ALAN GANN
& K.K. SHEFFIELD**
7,855 ACRES (TR 2)
V. 1495, P. 1119

MARGIE LEE MCBRIDE
81,624 ACRES
V. 2885, P. 1228
COESC. IN V. 359, P. 591

NW/4 OF SEC. NO. 362
M.E.P. & P. RR. CO. SURVEY
(P. BYRD SURVEY)
ABSTRACT NO. 1719

E. & M. CAMERON
LIVING TRUST
20 ACRES (TR 1)
V. 1903, P. 646

NE/4 OF SEC. NO. 362
T. & P. RR. CO. SURVEY
(R. LONG SURVEY)
ABSTRACT NO. 1839

CONSUELO, LTD.
40,844 ACRES (TR 1)
V. 2781, P. 1119

PLAT OF SURVEY AND IMPROVEMENTS

OF A 117,525 ACRES TRACT OF LAND OUT OF SECTION NO. 361, T. & P. RR. CO. SURVEY,
ABSTRACT NO. 1545, PARKER COUNTY, TEXAS

SURVEYED ON THE GROUND: FEBRUARY 12, 2020

MICHAEL PRICE, REGISTERED PROFESSIONAL LAND SURVEYOR NO. 5492
PRICE SURVEYING, LP, FIRM #10034200, 213 S DAK AVE, MINERAL WELLS, TX 76067
940-325-4841 JN20096 19295.crd FN200325

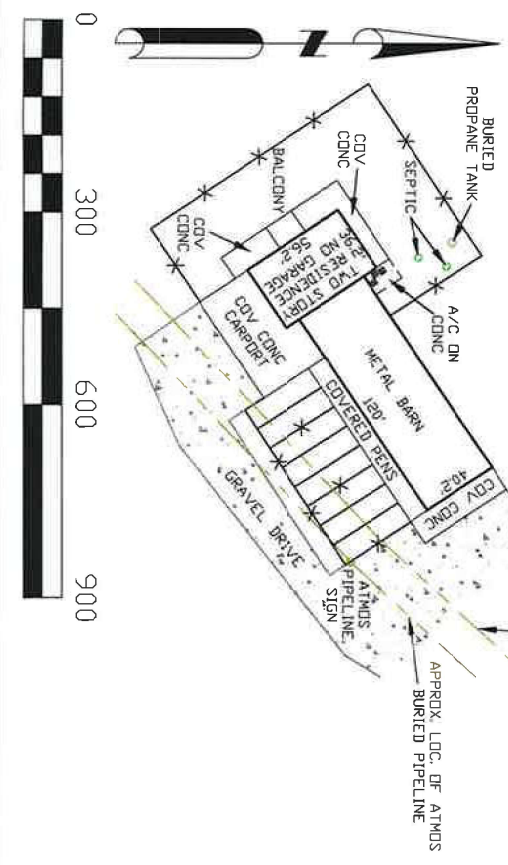

NOTE: THE SURVEYOR HAS MADE NO INVESTIGATION OR INDEPENDENT SEARCH FOR EASEMENTS OF RECORD, ENCUMBRANCES, RESTRICTIVE COVENANTS, DWNSHIP TITLE EVIDENCE, OR ANY OTHER FACTS THAT A CURRENT TITLE SEARCH MAY DISCLOSE.

NOTE: ALL DISTANCES ARE SURFACE DISTANCES

NOTE: A PORTION OF THIS TRACT IS IN A FLOOD ZONE ACCORDING TO FIRM MAP NO. 483670225P, DATED APRIL 5, 2019

NOTE: SET 1/2" IR. V. CAP (PRICE SURVEYING)

ADDRESS: 625 N. PLUM ST
MILLSAP, TX 76066

BEARING BASIS:
TEXAS STATE PLANE COORDINATE SYSTEM, NAD83
NORTH CENTRAL TX ZONE, US SURVEY FOOT

