

89 Acres of Raw Land

Salesville, Palo Pinto County, Texas



Mesquite Flat to Rolling Terrain w/Live Oaks & Cedar w/Native Grasses.



3 Stock Ponds, Good Hunting, Fenced & Older Steel Cattle Pens.



Highway Frontage & Minerals with Production Income!
\$352,284.70.

Office 940-682-4993
Office 940-682-7751

MAC A. COALSON
REAL ESTATE BROKER

Cell 817-925-3333
Fax 940-682-4322

7801 New Authon Road, Weatherford, TX 76088

E-Mail - Mac@Coalson.com

McALLEN COALSON - Agent / Broker, Direct Office Line 940-682-7660

Cell 817-991-8300 E-Mail - McAllen@Coalson.com

WWW.COALSON.COM



Office 940-682-4993

COALSON REAL ESTATE

Cell 817-925-3333

MAC A. COALSON, Sr. Broker - Direct Office Line 940-682-7660

E-Mail - Mac@Coalson.com

McALLEN COALSON, Broker - Cell 817-991-8300

E-Mail - McAllen@Coalson.com

7801 New Authon Road, Weatherford, TX 76088

WWW.COALSON.COM



89 Acres of Raw Land Salesville, Palo Pinto County, TX

- LOCATION:** 1.5 miles West of Salesville (Peadville), TX or 1.5 miles West of HWY 281 and HWY 254/FM 1885 intersection on the North (Right hand side) of HWY 254 towards Graford, TX. 9.6 miles North of Mineral Wells, TX, 22 miles W/NW of Weatherford, TX, & 42 miles West of Fort Worth, TX.
- TERRAIN:** Mesquite Flat to Sloping terrain with numerous Live Oak Motts and Cedar with Native Grasses.
- WATER:** (3) - Stock Ponds.
- MINERALS:** Owner owns 1/2 of Minerals & Will Convey. Production Income = \$300-\$400 Per Month (Presently).
- TAXES:** \$154.68
- SCHOOL:** Mineral Wells I.S.D.
- COMMENTS:** Good Hunting (Deer & Turkey), Multiple Stock Ponds, Production Income, & HWY Frontage!
- PRICE:** \$352,284.70

ALL INFORMATION CONTAINED HEREON HAS BEEN OBTAINED FROM SOURCES DEEMED RELIABLE. NO REPRESENTATION OR WARRANTIES, EITHER EXPRESSED OR IMPLIED ARE MADE AS TO ITS ACCURACY BY SAID AGENT. THIS INFORMATION IS SUBJECT TO CHANGES, WITHDRAWAL, ERROR, OMISSION, CORRECTION, OR PRIOR SALE WITHOUT NOTICE SELLER CAN RECEIVE AND ACCEPT BACKUP CONTRACTS.

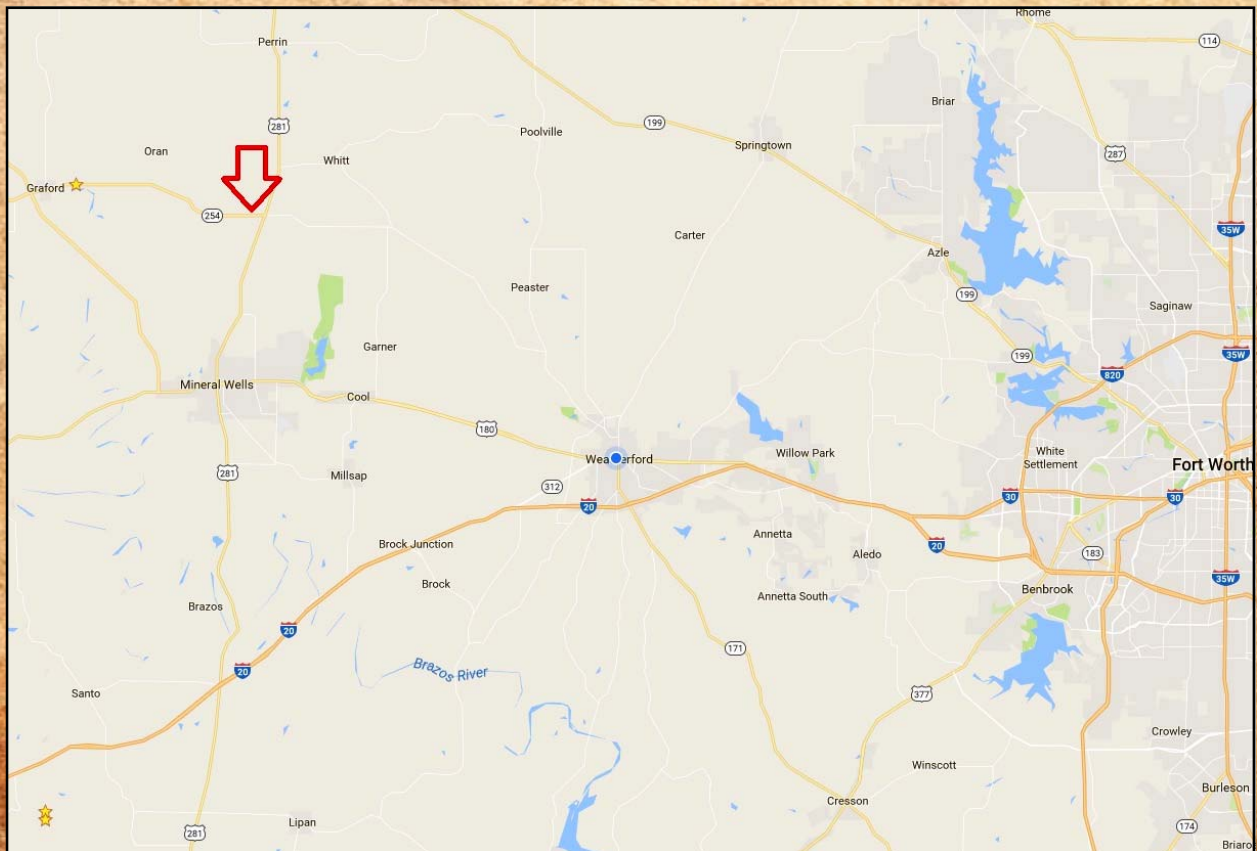
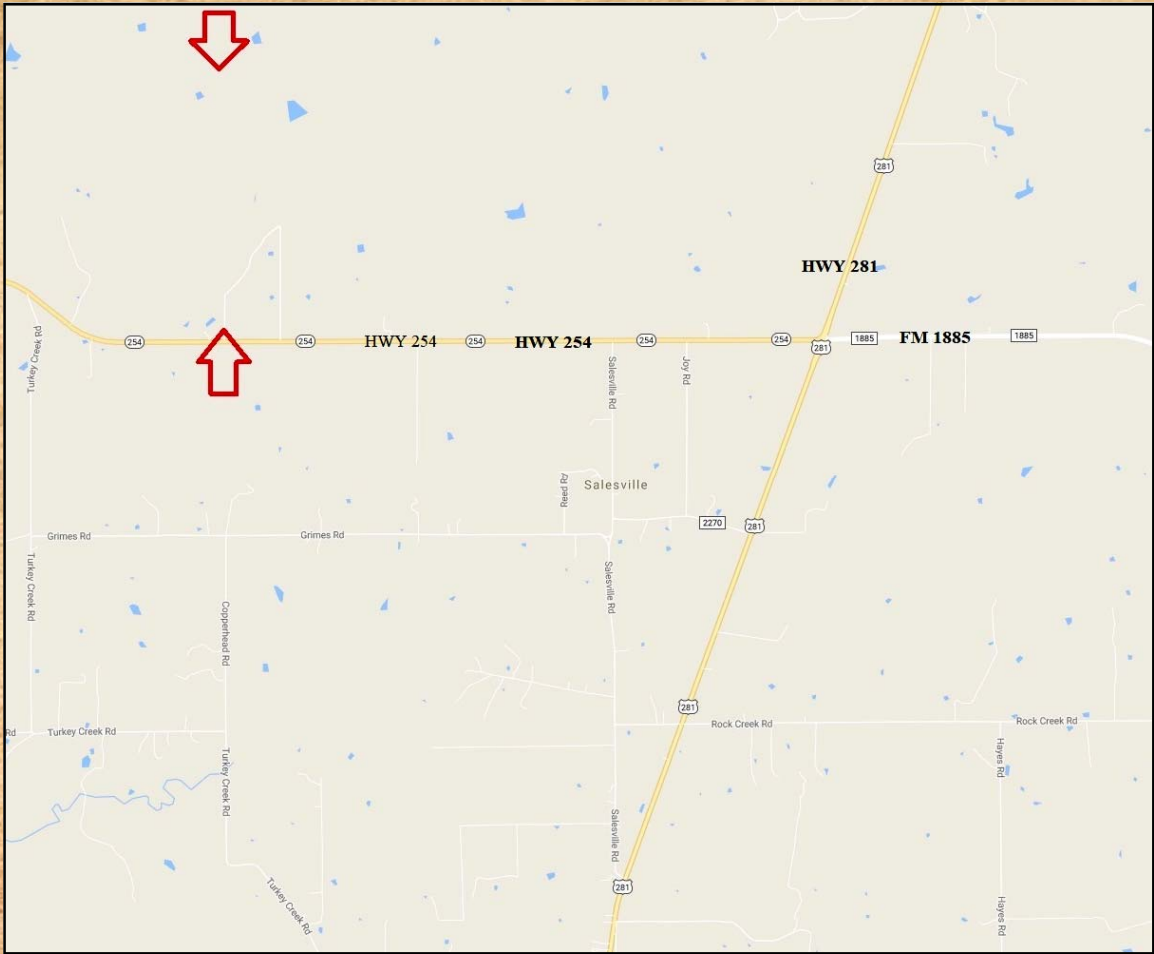



FM 254

FM 254

Red Line Boundaries are not exact